



THIS DRAWING IS THE PROPERTY OF "M.N. CONSULTANTS ONE DESIGN SOLUTIONS" AND IS MERELY LENT FOR LIMITED USE SUBJECT TO THE CONDITION THAT IT SHALL NOT BE REPRODUCED LENT OR USED IN ANY WAY DETRIMENTAL TO OUR INTEREST

Sl. NO.	TYPE	WIDTH (R.O.)	SILL (R.O.)	LINTEL (R.O.)	SIZE (R.O.)
1.	D1	1800	0	2400	1800X2400
2.	D2	1200	0	2100	1200X2100
3.	D3	1000	0	2100	1000X2100
4.	D4	1000	0	2100	1000X2100
5.	D5	900	0	2100	900X2100
6.	D6	900	0	2100	900X2100
7.	D7	750	0	2100	750X2100
8.	CP1	160	0	2100	160X2100
9.	SD1	2400	0	2100	2400X2100
10.	SD2	2000	0	2100	2000X2100
11.	SD3	1400	0	2100	1400X2100
12.	SD4	1300	0	2100	1300X2100
13.	SD5	1200	0	2100	1200X2100
14.	FC5	7300	0	2100	7300X2100

Sl. NO.	TYPE	WIDTH (R.O.)	SILL (R.O.)	LINTEL (R.O.)	SIZE (R.O.)
1.	W1	1800	450	2100	1800X2100
2.	W2	1500	800	2100	1500X2100
3.	W3	1200	800	2100	1200X2100
4.	W4	900	1150	2100	900X2100
5.	W5	600	1150	2100	600X2100
6.	W6	600	1150	2100	600X2100

- NOTES:**
- ALL DIMENSIONS & LEVELS ARE UNFINISHED DIMENSIONS & LEVELS IN MM UNLESS MENTIONED OTHERWISE.
 - ALL EXTERNAL WALLS ARE A COMBINATION OF RCC WALLS & BLOCK WORK.
 - THIS DRAWING SHALL BE READ IN CONJUNCTION WITH DETAILS, LARGE SCALE DRAWINGS, STRUCTURAL, ELECTRICAL AND OTHER RELEVANT DRAWINGS.
 - ALL GREEN & WATER BODY AREAS PROVIDED WITHIN THE SITE AREA SHALL BE SHARED BETWEEN THE PRESENT AND FUTURE PROJECTS.
 - ALL SERVICE AREAS SHALL BE SHARED BETWEEN THE PRESENT AND FUTURE PROJECTS.
 - ALL ROADS SHALL BE ACCESSED AND SHARED BETWEEN THE PRESENT AND FUTURE PROJECTS.
 - THE REMAINING PARTS AND SCOPE COVERAGE FROM THE PRESENT PROJECT SHALL BE USED IN FUTURE PROJECT.
 - DEVELOPER IS ALSO ALLOWED TO INTRODUCE MECHANICAL STACK PARKING IN ALL OPEN PARKING AREAS AS PER DEVELOPER'S DISCRETION AS PER BIDDING DOCUMENTS APPROVALS.
 - THIS DRAWING SHALL BE USED FOR THE PURPOSES MENTIONED AND SHALL NOT BE USED FOR ANY OTHER PURPOSE WITHOUT WRITTEN CONSENT FROM THE ARCHITECT.

(Signature)
SIGNATURE OF OWNERS

CERTIFICATE OF STRUCTURAL ENGINEER:
THIS IS TO CERTIFY THAT THE STRUCTURAL DESIGN AND DRAWING OF BOTH FOUNDATION AND SUPER STRUCTURE OF THE BUILDING HAS BEEN MADE BY ME CONSIDERING ALL POSSIBLE LOADS INCLUDING THE SEISMIC LOAD AS PER THE NATIONAL BUILDING CODE OF INDIA AND CERTIFIED THAT IT IS SAFE AND STABLE IN ALL RESPECTS.

(Signature)
ANIKET AGARWALA
Structural Engineer
CA/200107297

SIGNATURE OF STRUCTURAL ENGINEER

CERTIFICATE OF ARCHITECT:
I HEREBY CERTIFY WITH FULL RESPONSIBILITY THAT THE BUILDING PLAN HAS BEEN DRAWN UP AS PER WEST BENGAL MUNICIPAL BUILDING RULES 2007 AS AMENDED FROM TIME TO TIME THAT THE WIDTH OF THE ABUTTING ROAD CONFORM WITH THE PLAN AND IT IS A BUILDABLE SITE, NOT A TANK OR A FILLED UP TANK. THE SITE PLAN, LOCATION PLAN AGREES WITH THE SITE. THE PLOT IS DEMARCATED BY BOUNDARY WALLS & MEASUREMENTS TALLY WITH THE REGD. DEED PLAN. THE CONSTRUCTION OF U.G.W.R. & S.T.P. WILL BE COMPLETED UNDER GUIDANCE OF ARCHITECT & E.S.E.

(Signature)
ANIRBAN BAKSHI
Architect
Council of Architects
CA/200107297

SIGNATURE OF ARCHITECT

Project:
PROPOSED GODREJ PRAKRITI HOUSING COMPLEX FOR ADDITION & ALTERATION PLAN FOR TOWER Q, TOWER R & MCLP AT 187F/1.B.T.ROAD,KOLKATA-700115, WARD NO-14 (UNDER PANIHATI MUNICIPALITY)

Client:
GODREJ PROPERTIES LTD.

Consultant:
M.N CONSULTANTS ONE DESIGN SOLUTIONS
1516, Rajdanga Main Road, Kolkata-700107.
Telephone : 033 40165700.
Email: mn_codes@gmail.com
Web: www.mno-one.com

- Drawing Title:**
- TOWER-R (RESIDENTIAL)
 - TYPICAL FLOOR PLAN AT 7TH, 12TH, & 17TH FL. LVL. (WITH FIRE REFUGE BALCONY)
 - ROOF PLAN
 - ABOVE ROOF PLAN
 - DETAIL OF O.H.W.T.

Scale: 1:100, 1:50	Date: 31.07.2019
Drawn: SAHAN	Checked: ANIRBAN
Approved: ANIRBAN	
<input checked="" type="checkbox"/> Design Development <input type="checkbox"/> Contract Document <input type="checkbox"/> Construction Dwg <input type="checkbox"/> As Built Dwg	<input type="checkbox"/> Section Dwg <input type="checkbox"/> As Built Dwg
Revision No:	Revision Date:
RD	
Drawing No: GP-SD-10	
Job No: 2019-2019/26/GP	

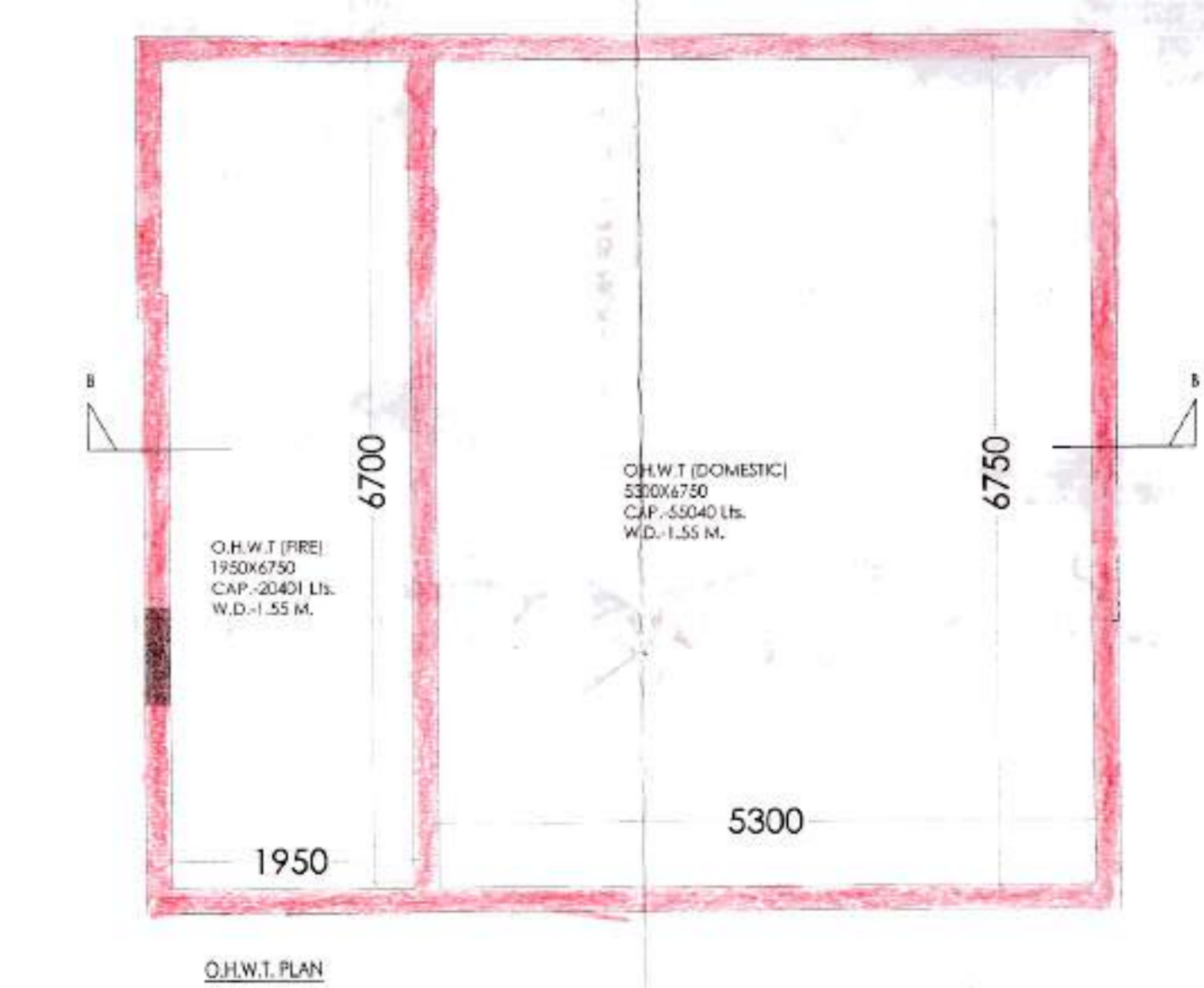
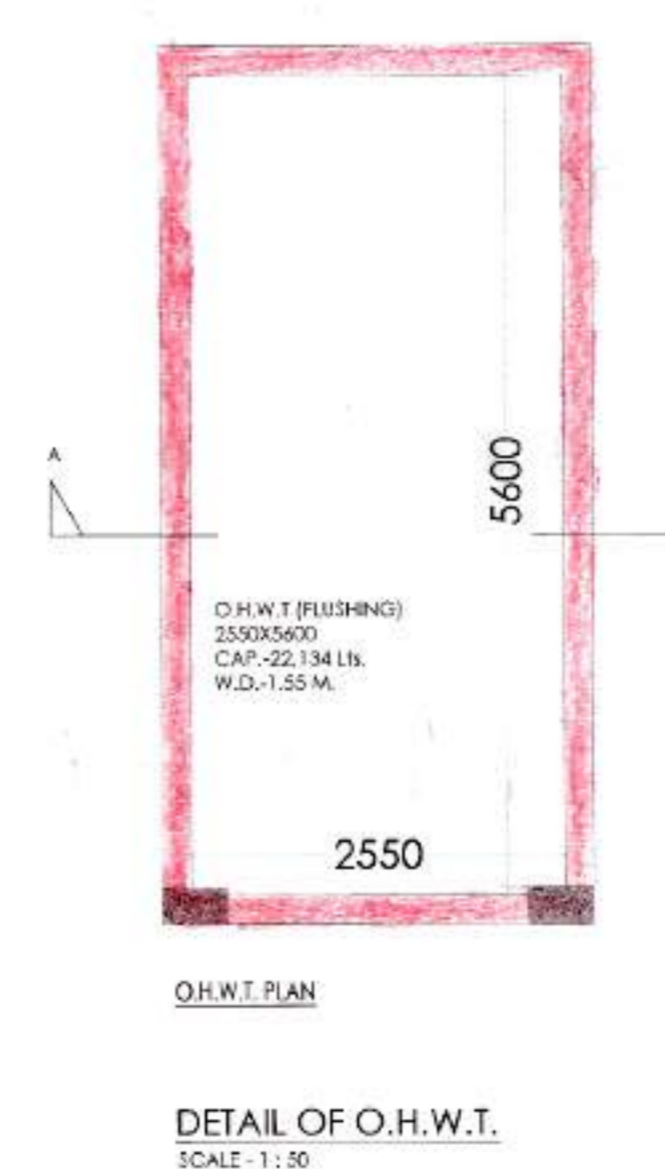
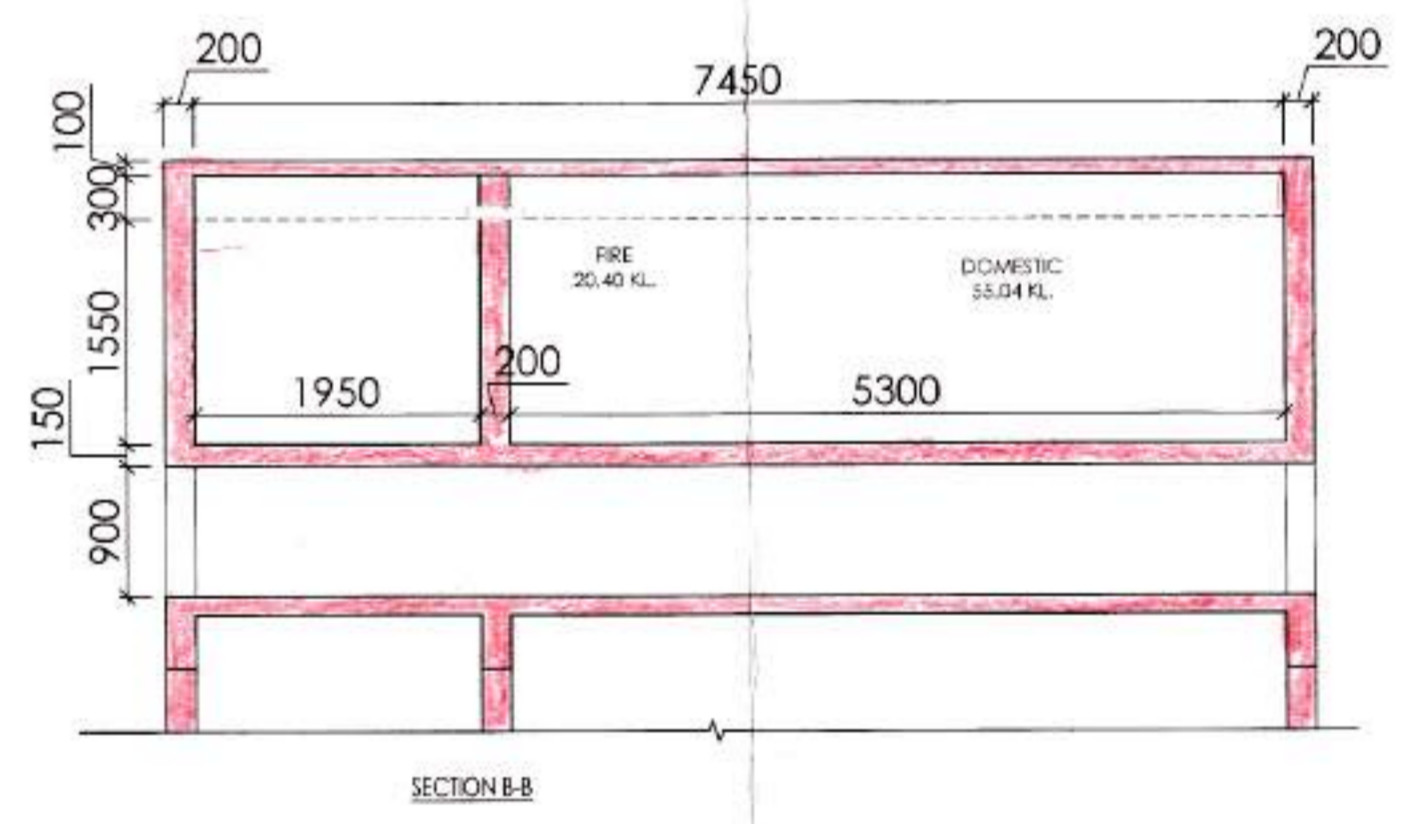
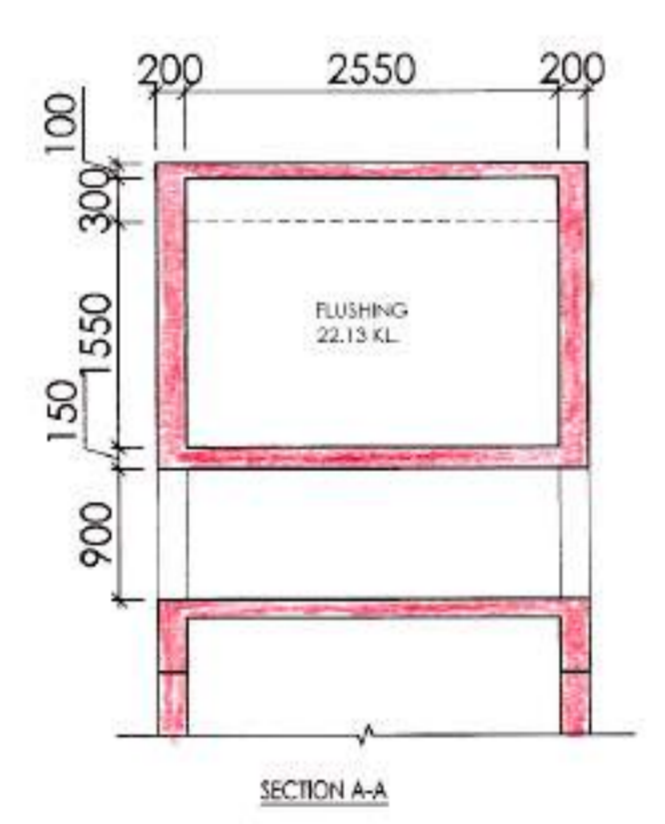

273
12 6 NOV 2018
The City Engineer, Panhaji Municipality, has reviewed the Master Plan and the contract and found it satisfactory and approved the same. The amount of Rs. 10000/- is sanctioned for the purpose of the contract. The sanction is valid for one year from the date of sanction.

[Signature]
Sub Assistant Engineer
Panhaji Municipality

[Signature]
Asst. Engineer
Panhaji Municipality

SANCTIONED
[Signature]
Executive Officer
Panhaji Municipality